

MANUAL

SW200A SW200B

www.smartpower.co.in

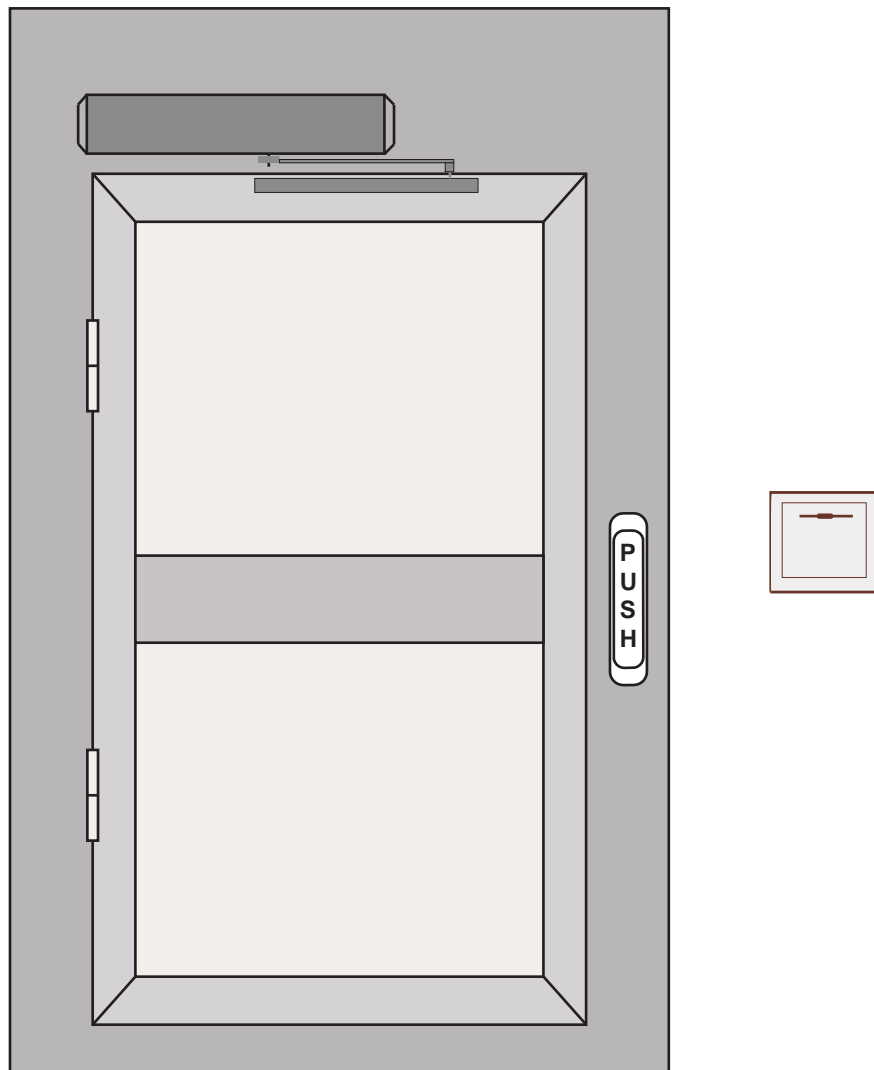

AUTOMATIC ENTRANCE SPECIALISTS

Content

1	Technical Parameters	1
2	Components	2
3	Installation step	3-10
3.1	Installation of bottom plate (SW200A)	3
3.2	Installation of bottom plate (SW200B)	4
3.3	Installation of pull bar (Right)	5
3.4	Installation of pull bar (Left)	6
3.5	Installation of push bar (Right)	7
3.6	Installation of push bar (Left)	8
3.7	Finished installation	9
3.8	Installation of drive and cover	10
4	Wired digram	11-13
4.1	Terminal details of controller	11
4.2	Date setting	12
4.3	Connection of commonly used and special function	13
5	Trouble shooting	14

1. Technical Parameters

Power : AC200v-250v

Working speed: 3~8s

Opening time: 1~60s

Temperature: -20 °C ~+55 °C

Protection class: IP12D

Weight: 6.5Kg

Dimension: SW200A 515×95×80mm(L*H*W)

SW200B

mm=Door width



Suitable range

kg=Door weight



Limit range

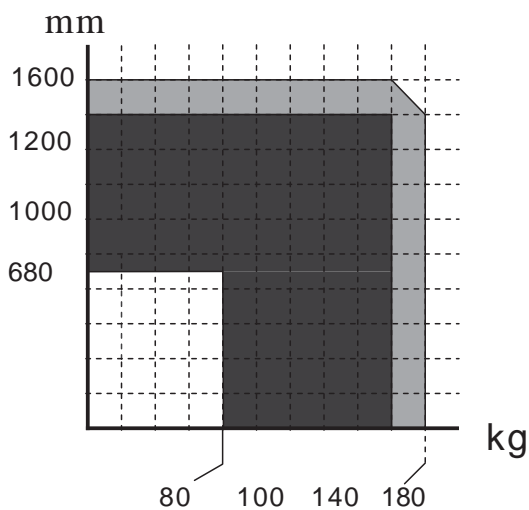

SW200A

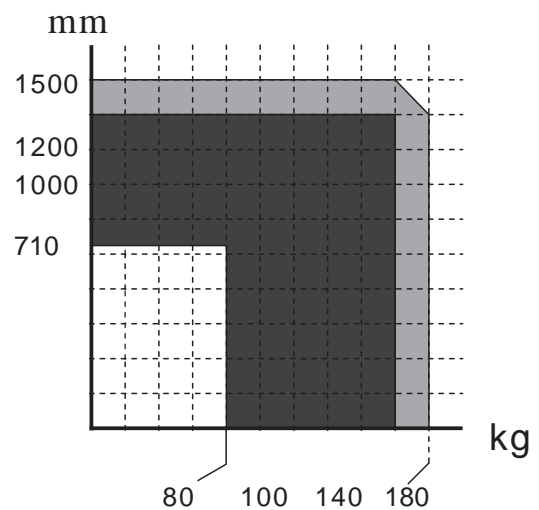

SW200B

1. Components

SW200A

	底板
	拉臂 盖板
	拉臂固定座
	机组
	
	底板
	拉臂 盖板
	拉臂固定座
	机组 (配后备电源)

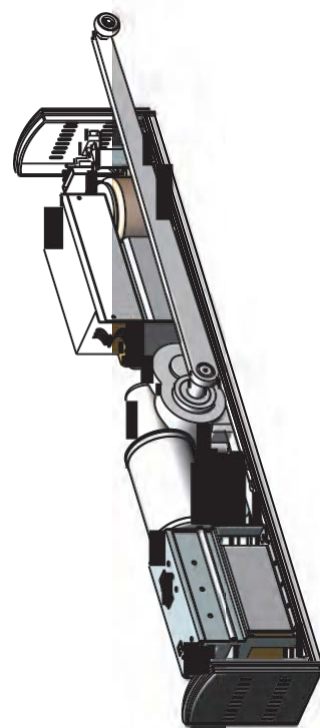
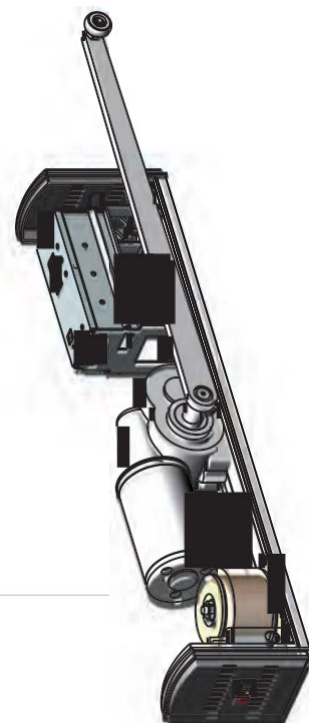

3. Installation step

3.1 Installation of bottom plate

Pull bar type (SW200A)

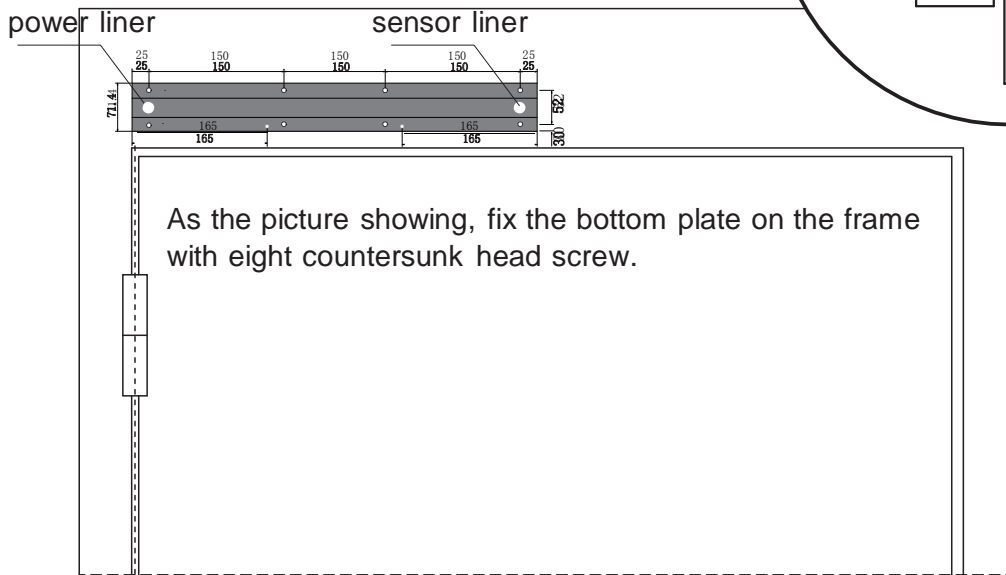
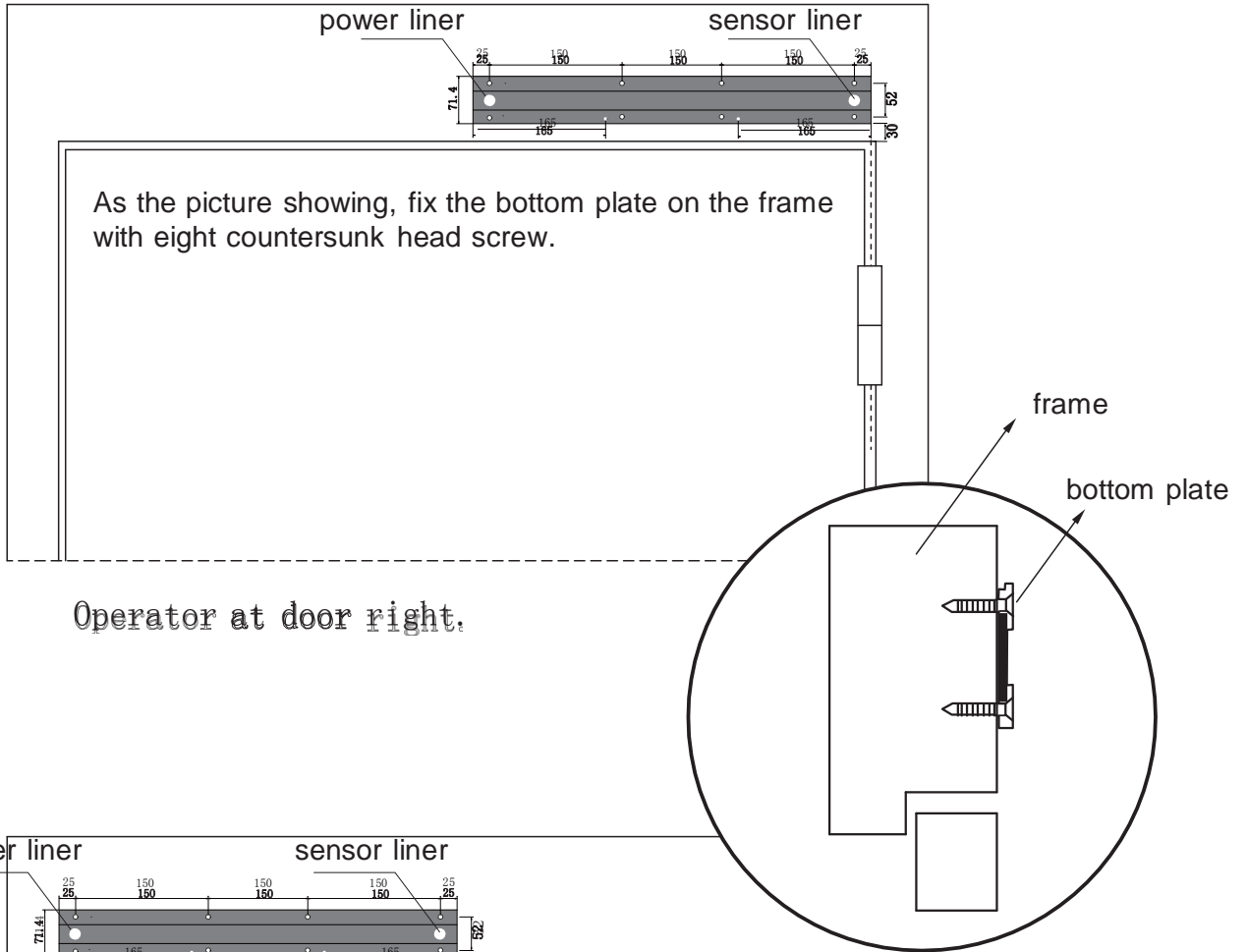

3. Installation step

3.2 Installation of bottom plate

Pull bar type (SW200B)

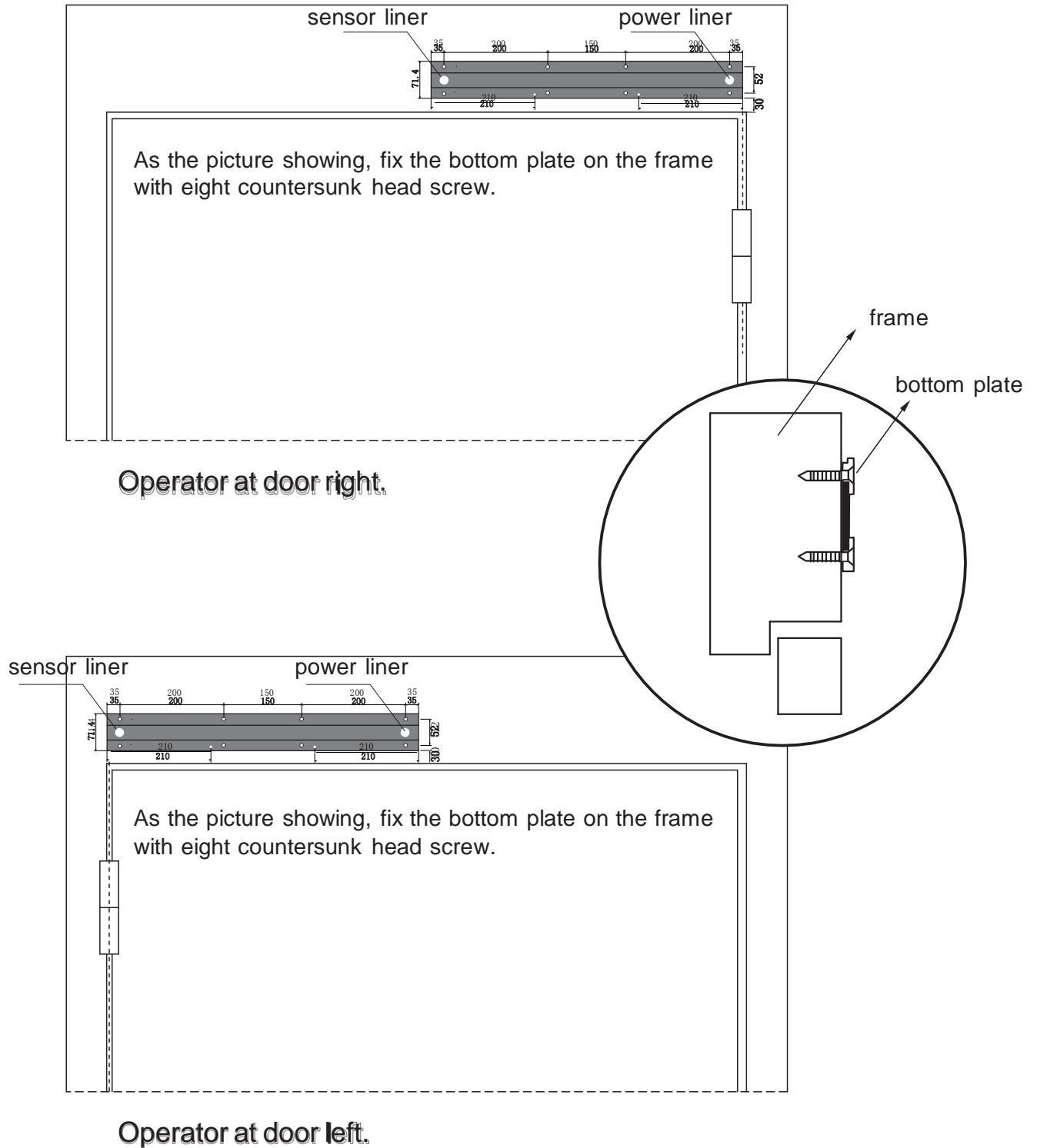

3. Installation step

3.3 Installation of pull bar

A. Right installation

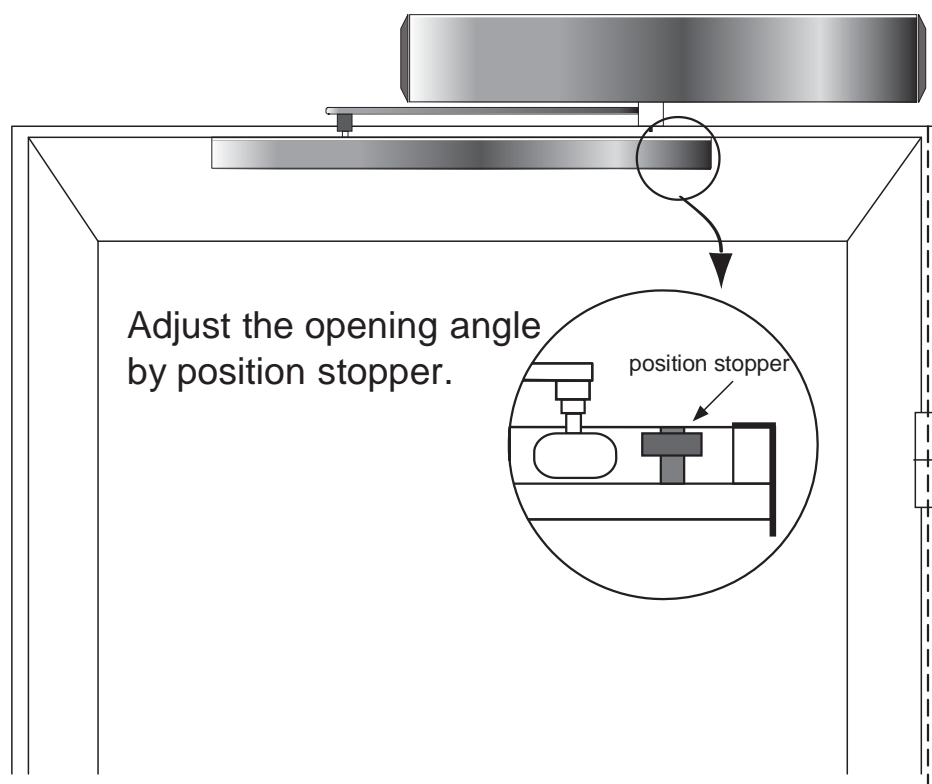
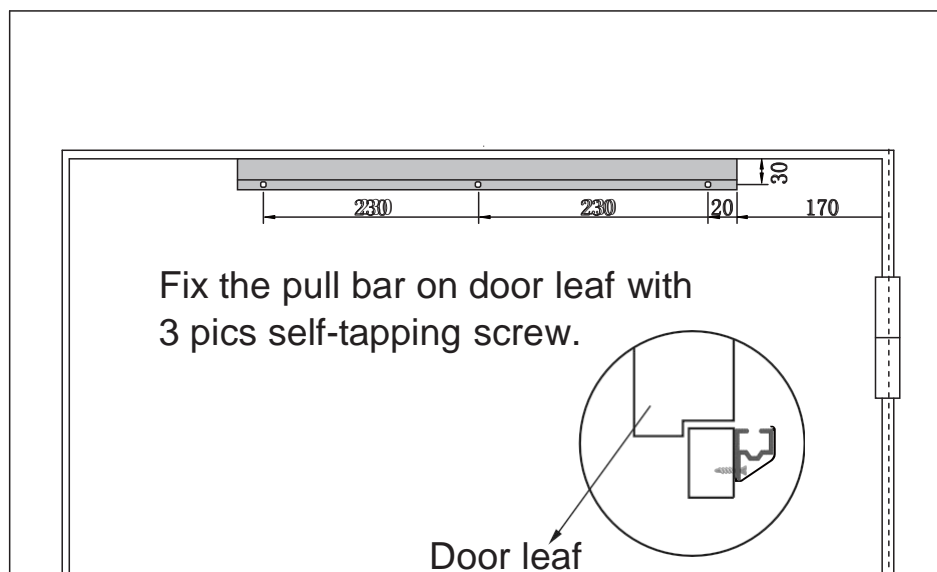

3. Installation step

3.4 Installation of pull bar

B. Left installation

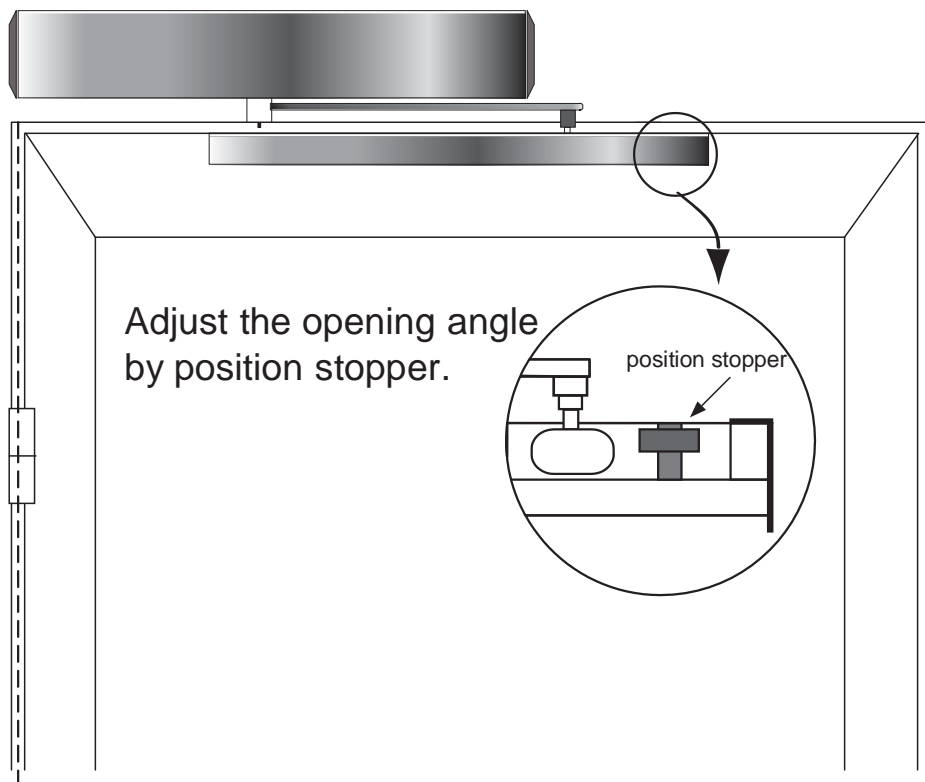
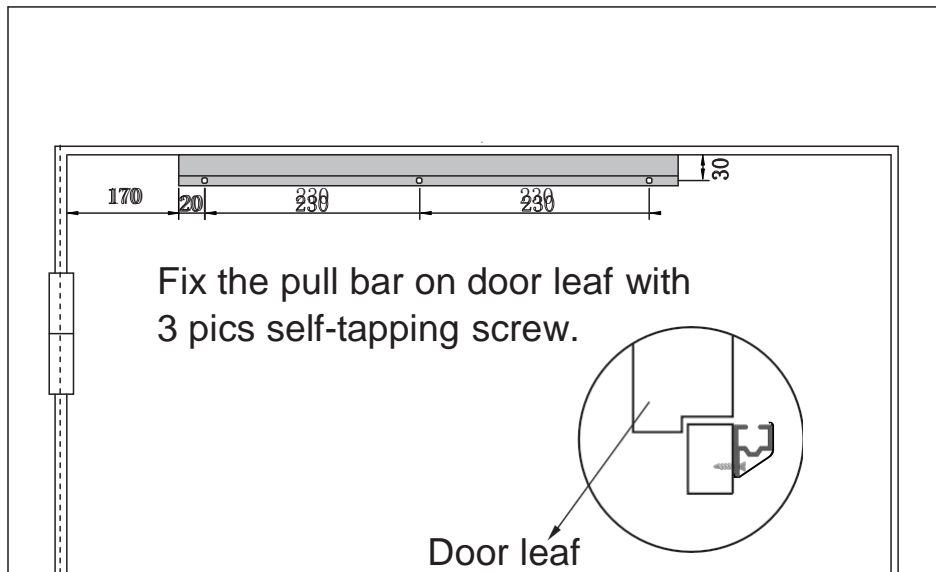

3. Installation step

3.5 Installation of push bar (如果有门边框, 不适合安装)

A. Right installation

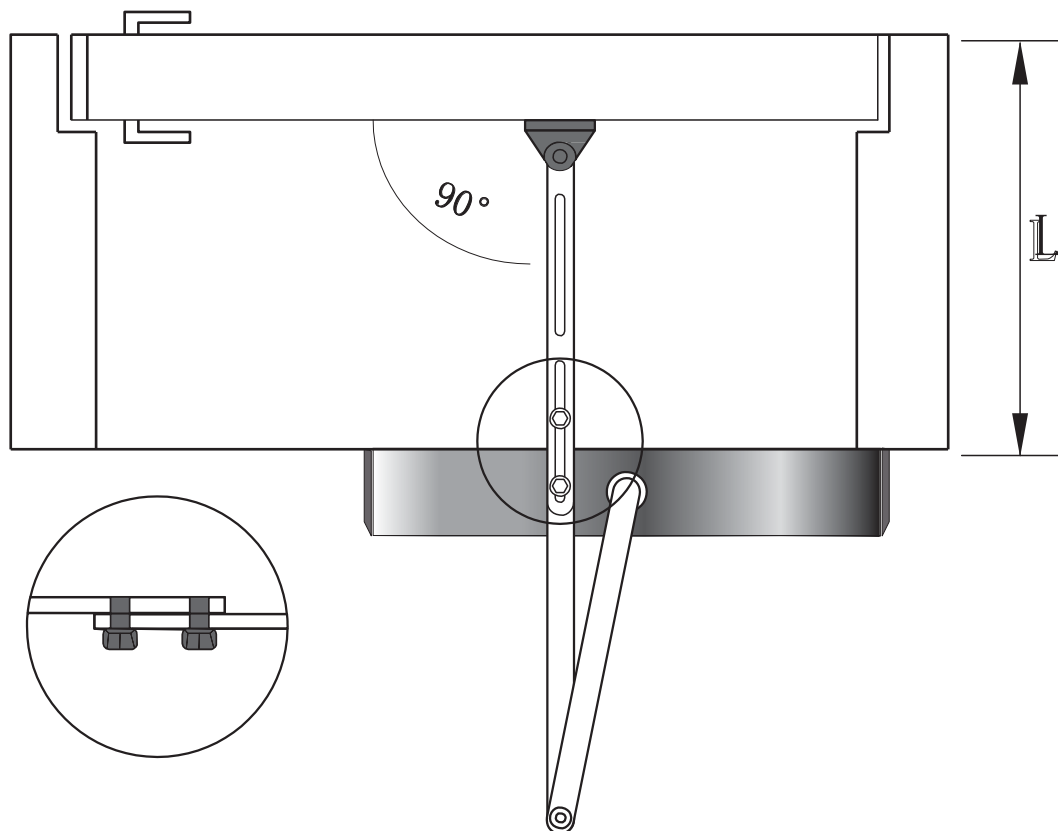
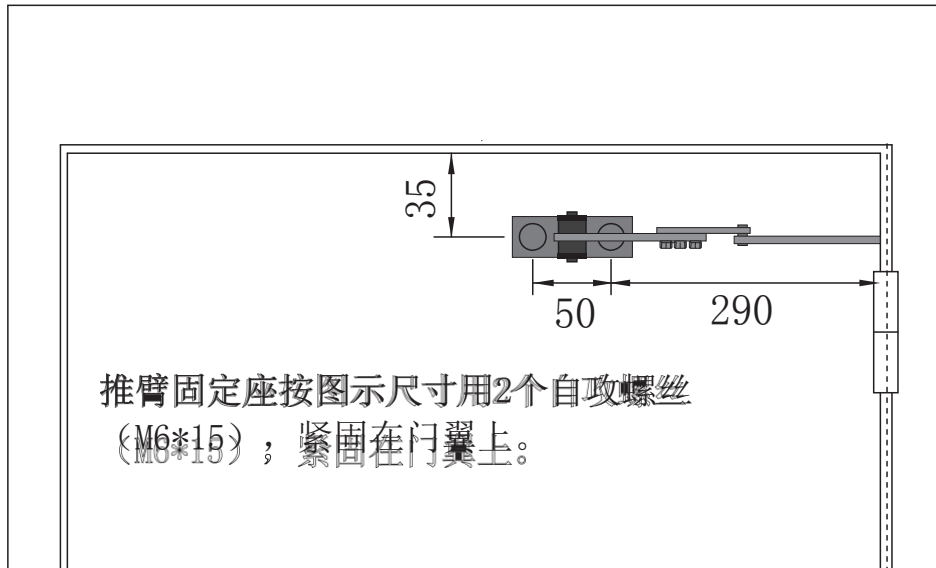

Adjust the push bar length by two screw according to the door frame's depth(L).

3. Installation step

3.6 Installation of push bar (如果有门边框, 不适合安装)

B. Left installation

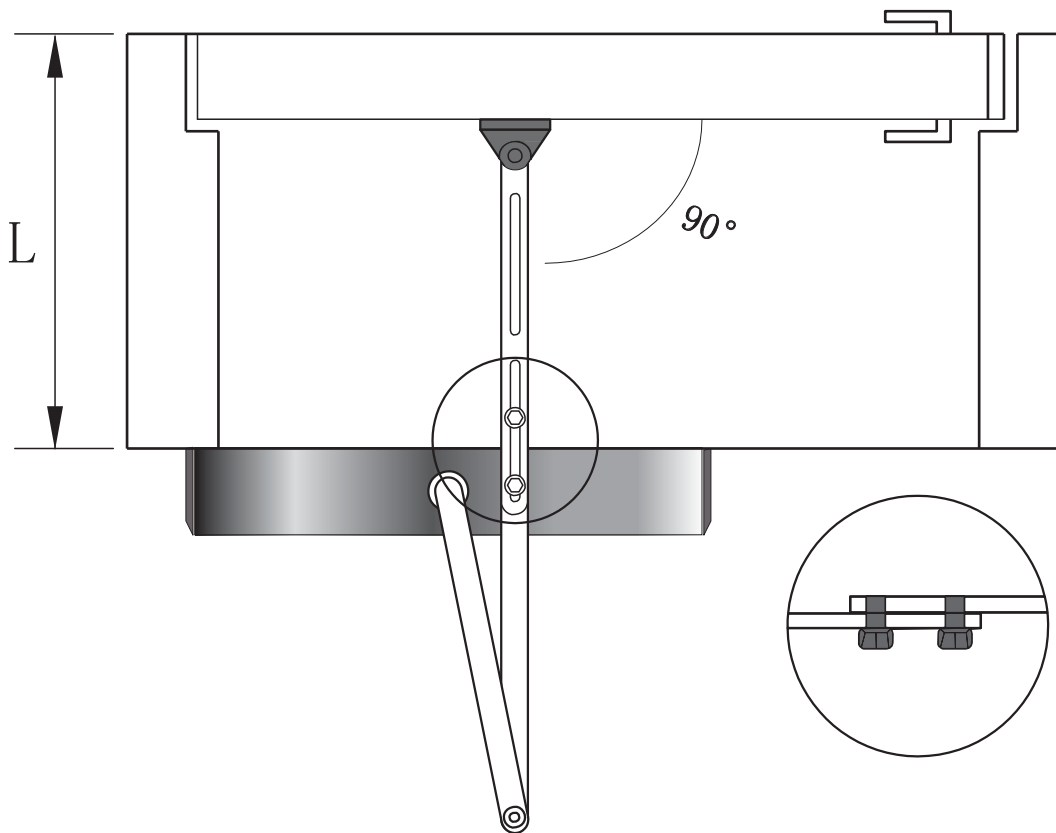
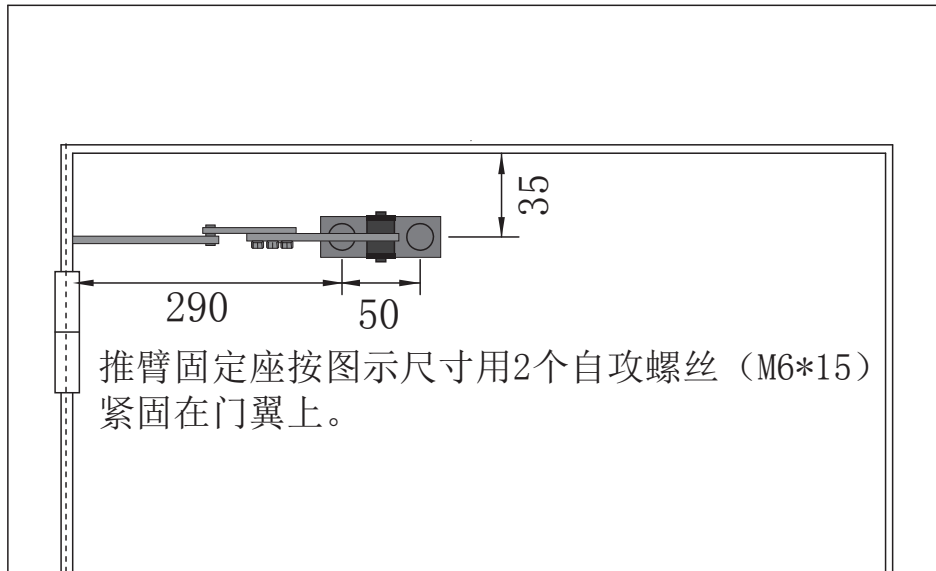

Adjust the push bar length by two screws according to the door frame's depth(L).

3. Installation step

3.7 Finished installation

Pull bar: Door leaf open toward inside (same direction as operator)

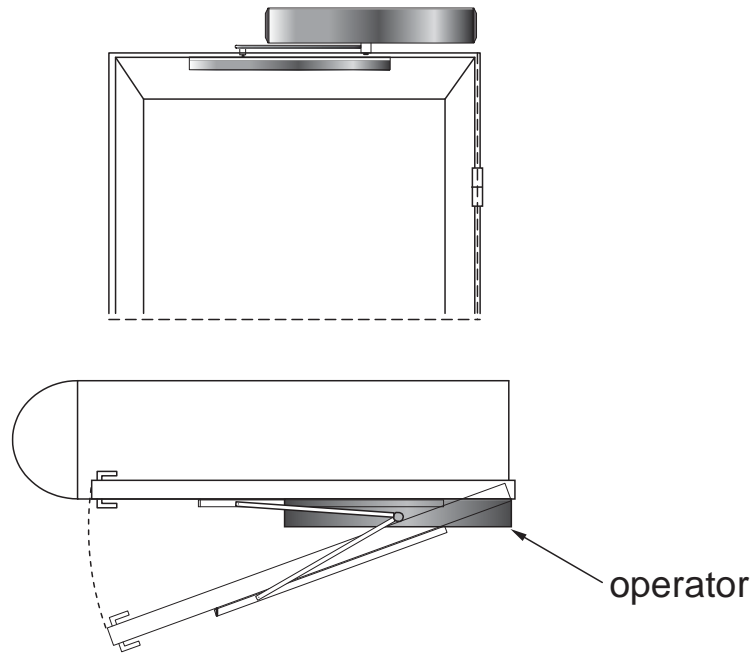

Push bar: Door leaf open toward outside (opposite direction as operator)

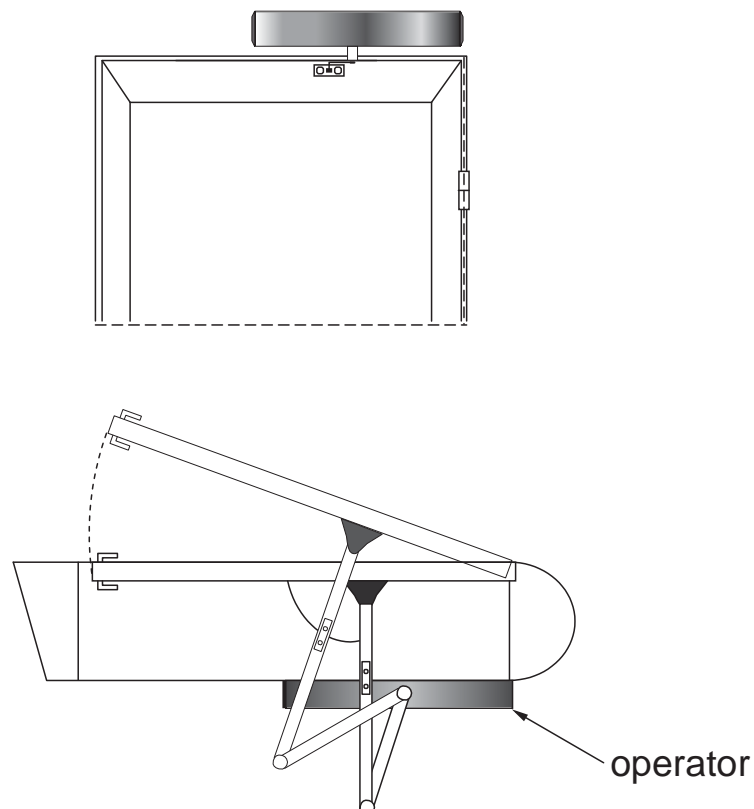

3. Installation step

3.8 驱动系统安装

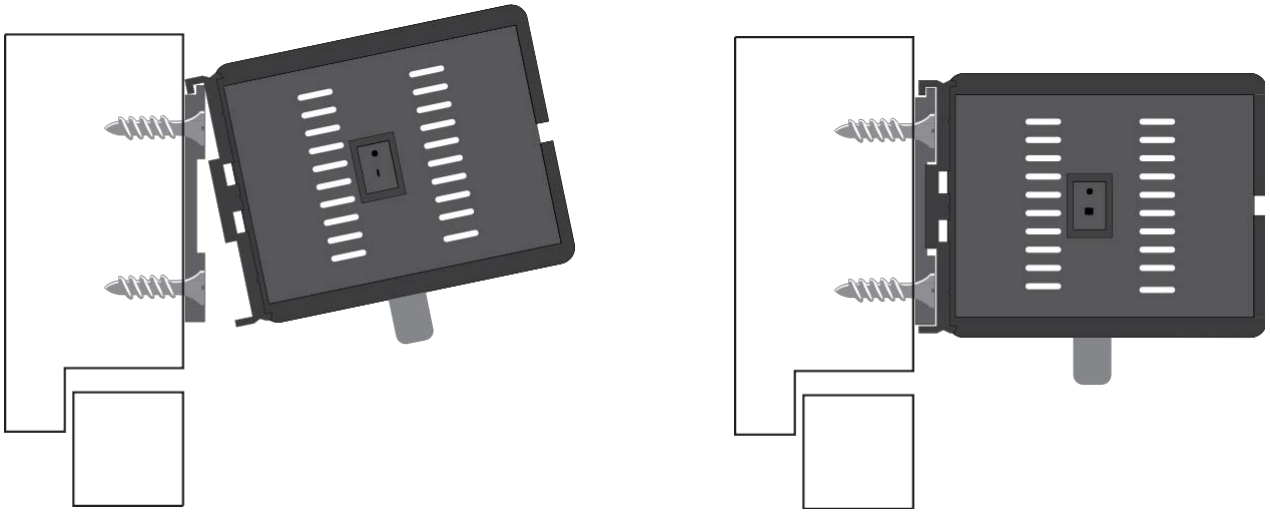

将驱动系统按图示钩挂在已安装好的底板上，用8个内六角圆柱头螺丝紧固。

3.9 机罩的安装与拆卸

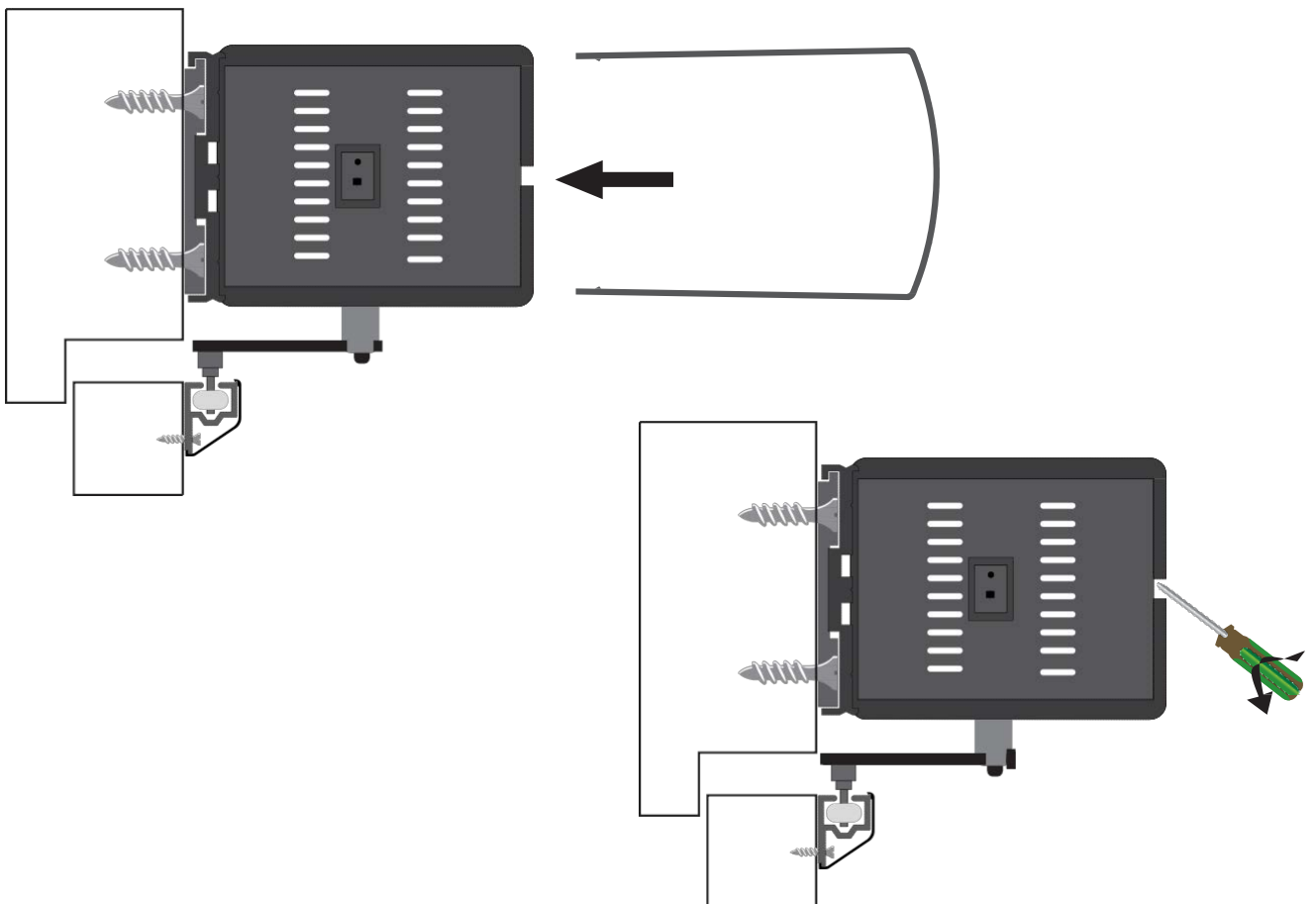

4. 电气连接

4.1 接线端口说明

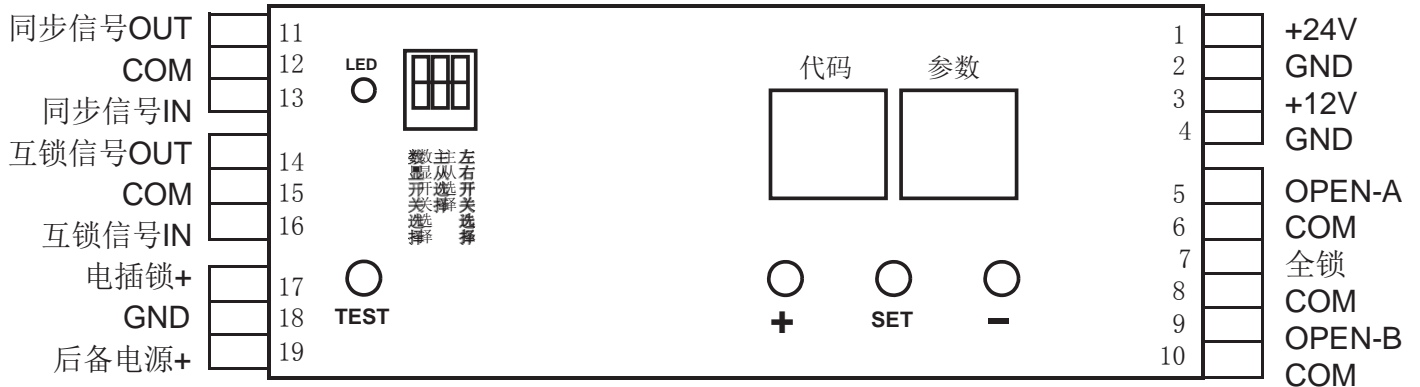

20 调节说明:
 21 Press "+" "-" button to adjust to the desired code , then press the "set" key
 22 LED is blinking , that enter the parameter adjustment mode. At this point press "+" "-"
 23 Key , the parameter is adjusted to the desired value , press the "set" button to confirm (not flashing digital

+24V
+12V
GND
closed
crash
door
crash

4.2 Parameter adjustment instructions

代码	参数范围	出厂值	Features
01	30-99	53	Fast line speed door
02	30-99	43	Closing fast line speed
03	5-29	9	Open amble speed
04	5-29	8	Postponed closing speed
05	1-5	1	That pushed the door open efforts
06	0-5	0	When the door is closed, closed force
07	0-1	0	Door mode selection 0 : Push the door that is open 1 : Push the door closed to increase the force
08	0-1	0	Electric lock mode selection 0 : All- lock signal lock 1 : power locks closed
09	0-60	2	Open pause time
10	5-30	15	Learning Speed

选配件: 遥控器

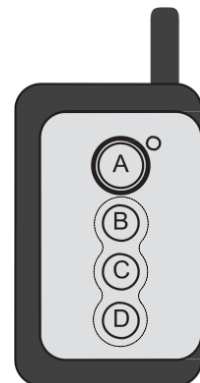

- A: 恢复正常
- B: 全锁
- C: 开门
- D: 半开

4. 电气连接

电插锁接线

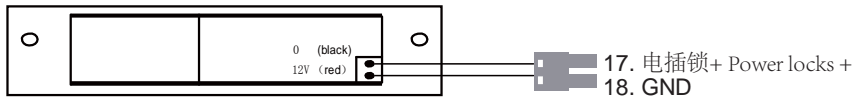

双门互锁



双门同步



24G感应探头

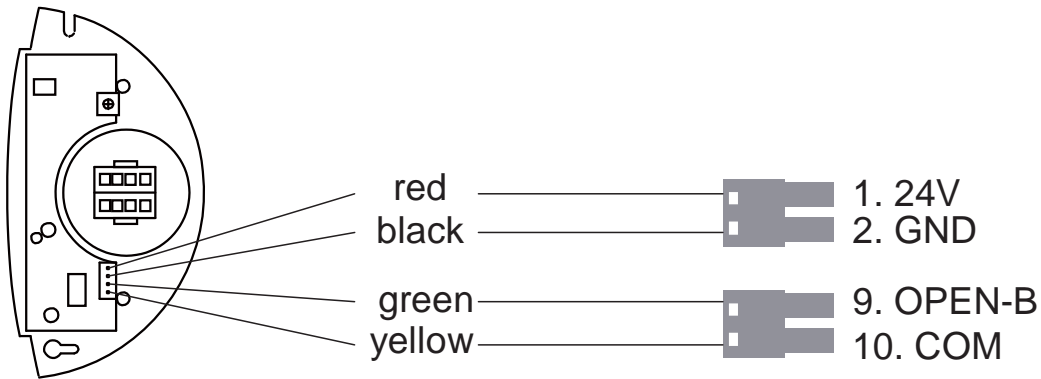

后备电源

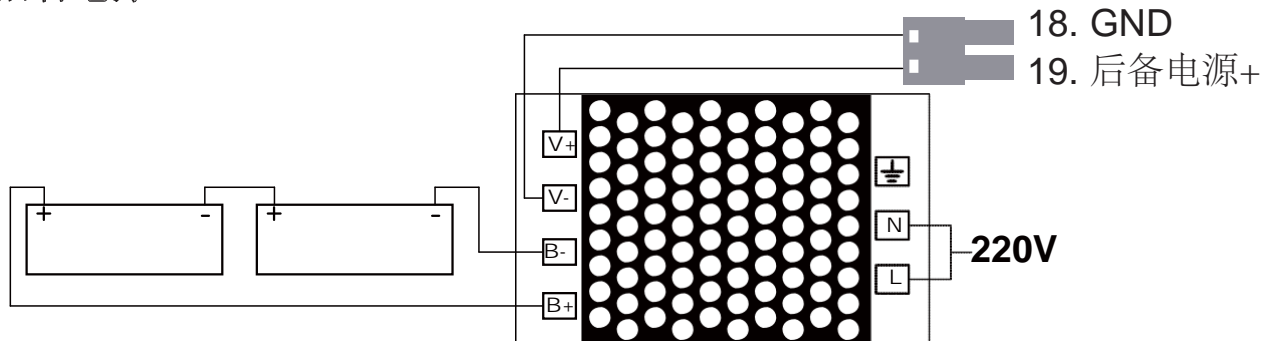

4. 电气连接

开门防撞感应器

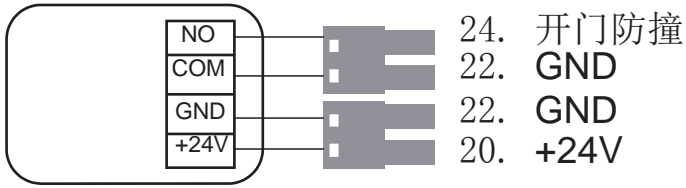

关门防撞感应器

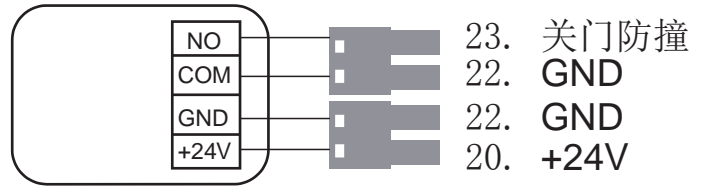

手按开关 PB01

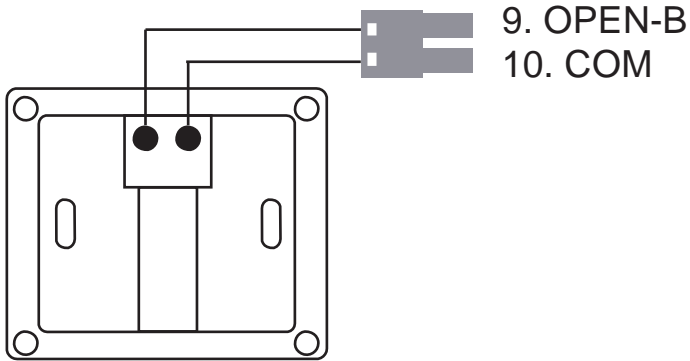

AK02

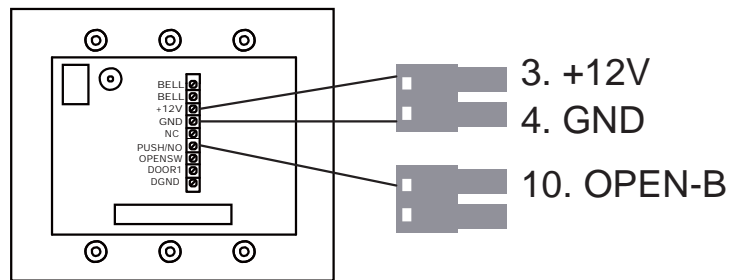

AK04

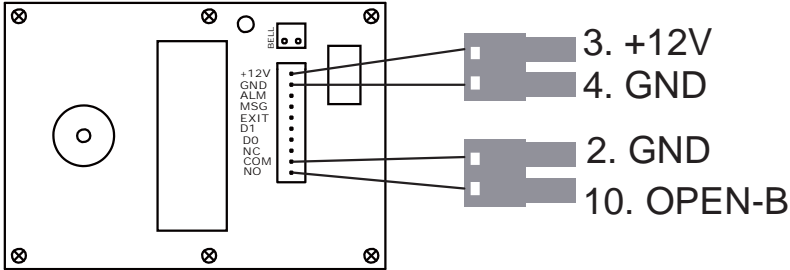

Special Instructions

- 1 remote control is built, just reprovision 4 key remote control, can achieve "normally open" "restore" "jog", "full lock" feature. You can also configure PB04 (wireless), realized the door function.
- 2 To achieve the outer lock function, just outside the accessory signal wire connected OPEN-B, door fittings signal line connected to the OPEN-A, then press the lock button on the whole, to achieve the outer lock function. (Full lock signal only lock OPEN-B, do not lock OPEN-A)
- 3 when making double open, according to the instructions received double doors sync signal lines. On power-up, all parameters of the controller to ensure that the same two doors, door debugging, if there is the phenomenon of speed, shutter speed can be adjusted switch, door switch amble speed, open pause time.

DIP switch master and slave select to use:

1 two doors simultaneously switch, the master from the selection DIP switch are appropriated above (re-power on after power failure valid)

2 switch must have two doors will be closed after opening the door of the main appropriated from the following DIP switch (power back on after a power outage valid)

www.smartpower.co.in

故障情况	The reason	Checklist	Deal with
门开关时不流畅 When the door switch is not smooth	Door closing speed or slow speed setting	The speed of confirmation	Adjust speed
	Learning speed setting is too smooth and intuitive feel	Size confirm learning speed	Resize
	Walking too much resistance	Confirm whether there are obstacles	Clear obstructions
Door switch Zhuangmen phenomenon	Postponed door open too fast		Adjusted to a suitable speed
	Loose stopper		Adjust the stopper to the appropriate position and tighten
The door is not operating	电源未接通	Check wiring blocks, motor unit's power switch	接通电源
	Learning speed setting is too low		The value of a slow learning speed transfer large
	门被锁	Are you sure the door is locked	打开门锁
	拉臂固定座内有垃圾	Open the pull arm mounts at both ends of the side cover to check whether there is garbage	清除垃圾
	Resistance is too large , swing for the protection of state		Power door after checking resistance
The door can not be opened	Obstructions on the open track		Clear obstructions
	Learning speed setting is too low		The value of a slow learning speed transfer large

